



TINEL-LOCK BACKSHELLS

NCAGE CODE: TD589

AS 9100

Quality System

www.atpsavunma.com

© 2026

INFORMATION ABOUT ATP ADAPTER FAMILY
TINEL-LOCK RING ADAPTERS

SERIES FOR	ATP BASIC PART NUMBER
❖ MIL-DTL-5015 (MS3100)	ATX18 (Page:2, 3, 4)
❖ MIL-DTL-26482 SERIES I	ATX21 (Page:5, 6)
❖ MIL-DTL-38999 SERIES III & IV ❖ EN3645	ATX40 (Page:7, 8)
❖ MIL-DTL-38999 SERIES I & II ❖ MIL-DTL-27599	ATX41 (Page:9, 10)
❖ VG96912 SERIES I	ATX47 (Page:11, 12)
❖ MIL-DTL-26482 SERIES II ❖ MIL-DTL-81703 SERIES I & II ❖ MIL-DTL-5015 CRIMP ❖ MIL-DTL-27599	ATX54 (Page:13, 14)



ATX18 – TINEL-LOCK SHIELDED BACKSHELL

CONNECTOR INTERFACE:

- ❖ MIL-DTL-5015 (MS3100)

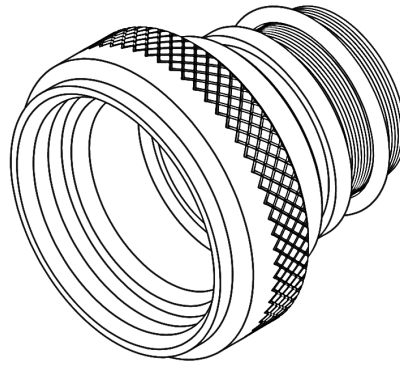

ATX	18	A	B	00	16	08	AI	
-----	----	---	---	----	----	----	----	--

SERIES _____
 ATX- RING INCLUDED (SEE RINGS OPTION)
 AT- RING NOT INCLUDED

CONNECTOR INTERFACE _____

MATERIAL (TABLE III) _____

FINISH (TABLE IV) _____

ANGLE _____

ORDER NUMBER (TABLE I) _____

ENTRY SIZE (TABLE II) _____

RING OPTION (SEE PAGE 15-16) _____

- AI - TO SUIT SINGLE BRAID
- BI - TO SUIT DOUBLE BRAID

MANUFACTURER CODE (TABLE V) _____



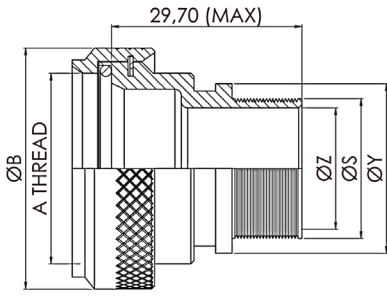

STRAIGHT BACKSHELL

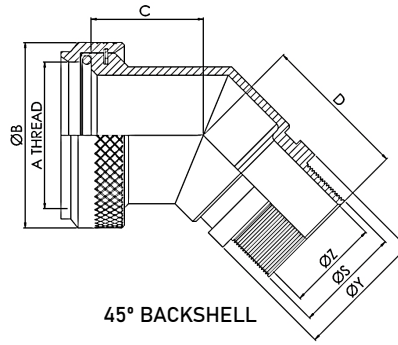

45° BACKSHELL

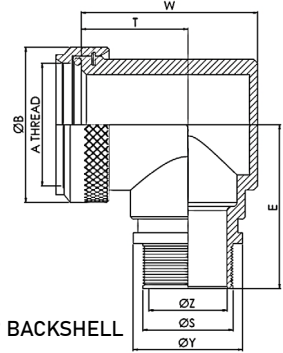

90° BACKSHELL

TABLE-I

ORDER NO.	SHELL SIZE	MANUFACTURER CODE	A THREAD	ØB MAX	C ±0,5	D ±0,5	W ±0,5	T ±0,5	E ±0,5	THESE DIMENSIONS APPLY IF BACKSHELL IS STAINLESS STEEL OR NICKEL ALUMINIUM BRONZE		
										W ±0,5	T ±0,5	E ±0,5
08	8S	B	3/8-32 UNEF	20,3	15,0	20,1	21,7	15,2	26,0	21,7	15,2	29,0
	8S	C	7/16-28 UNEF	20,3	15,0	20,1	21,7	15,2	26,0	21,7	15,2	29,0
	8S	A, R	7/16-27 UNS	20,3	15,0	20,1	21,7	15,2	26,0	21,7	15,2	29,0
	8S	D	*	20,3	15,0	20,1	21,7	15,2	26,0	21,7	15,2	29,0
10	10S	-	1/2-28 UNEF	22,0	15,4	21,6	23,2	15,7	27,7	23,2	15,7	31,2
11	10SL	C	9/16-24 UNEF	25,0	18,4	21,6	25,0	16,5	27,7	27,2	17,5	33,0
	10SL	A, B, R	5/8-24 UNEF	25,0	18,4	21,6	27,2	17,5	27,7	27,2	17,5	33,0
	10SL	D	*	25,0	18,4	21,6	27,2	17,5	27,7	27,2	17,5	33,0
12	12 & 12S	B, C	5/8-24 UNEF	27,0	18,4	21,6	27,2	17,5	27,7	27,2	17,5	33,0
	12 & 12S	A, R	1 1/16-24 UNEF	27,0	18,4	21,6	27,2	17,5	27,7	27,2	17,5	33,0
	12 & 12S	D	*	27,0	18,4	21,6	27,2	17,5	27,7	27,2	17,5	33,0
14	14 & 14S	-	3/4-20 UNEF	28,5	19,3	22,2	30,7	19,5	30,7	30,7	19,5	34,9
16	16 & 16S	-	7/8-20 UNEF	31,5	20,0	23,6	34,2	21,5	32,4	34,2	21,5	35,5
18	18	-	1-20 UNEF	35,0	20,6	23,7	37,2	23,0	34,0	37,2	23,0	37,2
20	20	A, B, C	1 1/8-18 UNEF	38,0	21,3	24,6	40,7	24,5	35,6	40,7	24,5	38,7
	20	R	1 1/8-24 UNS	38,0	21,3	24,6	40,7	24,5	35,6	40,7	24,5	38,7
	20	D	*	38,0	21,3	24,6	40,7	24,5	35,6	40,7	24,5	38,7
22	22	-	1 1/4-18 UNEF	41,0	21,9	25,0	43,7	26,0	37,1	43,7	26,0	40,2
24	24	-	1 3/8-18 UNEF	43,5	22,5	25,4	46,7	27,5	38,6	46,7	27,5	44,9
28	28	-	1 5/8-18 UNEF	50,5	23,6	25,4	51,7	30,0	41,1	51,7	30,0	46,0
32	32	B, C	1 7/8-16 UN	58,0	24,9	27,5	58,4	32,7	44,5	58,4	32,2	51,3
	32	A, R	1 29/32-18 UN	58,0	24,9	27,5	58,4	32,7	44,5	58,4	32,2	51,3
	32	D	*	58,0	24,9	27,5	58,4	32,7	44,5	58,4	32,2	51,3
36	36	B	2 1/16-16 UNS	63,5	27,5	29,0	67,7	38,0	49,1	67,7	38,0	54,3
	36	R	2 1/16-20 UNS	63,5	27,5	29,0	67,7	38,0	49,1	67,7	38,0	54,3
	36	C	2 1/8-16 UN	63,5	27,5	29,0	67,7	38,0	49,1	67,7	38,0	54,3
	36	A	2 1/8-18 UNS	63,5	27,5	29,0	67,7	38,0	49,1	67,7	38,0	54,3
	36	D	*	63,5	27,5	29,0	67,7	38,0	49,1	67,7	38,0	54,3
40	40	B	2 5/16-16 UN	70,0	30,1	30,1	72,2	41,1	51,3	72,2	41,1	57,5
	40	A, C, R	2 3/8-16UN	70,0	30,1	30,1	72,2	41,1	51,3	72,2	41,1	57,5
	40	D	*	70,0	30,1	30,1	72,2	41,1	51,3	72,2	41,1	57,5

1) All dimensions are in millimeters (mm). Specifications and dimensions subject to change.

2) **Manufacturer code D (*)**

Additional pieces supplied when manufacturer is unknown. All thread sizes for order number apply.



TABLE-II			
ENTRY SIZE	ØZ MIN	ØS	ØY ±0,3
04	6,35	9,49 ± 0,04	14,0
05	7,92	11,06 ± 0,04	15,5
06	9,53	12,66 ± 0,04	17,1
07	11,10	14,21 ± 0,07	18,7
08	12,70	15,81 ± 0,07	20,3
10	15,88	18,96 ± 0,08	23,5
12	19,05	22,14 ± 0,08	26,7
14	22,23	25,30 ± 0,08	29,8
16	25,40	28,48 ± 0,08	33,0
18	28,58	31,65 ± 0,08	36,2
20	31,75	34,83 ± 0,08	39,4
22	34,93	37,98 ± 0,08	42,5
24	38,10	41,15 ± 0,08	45,7

TABLE-III MATERIAL CODES		
Material	Material Code	Typical Applications
Aluminum alloy	A	Standard material for normal applications
Stainless steel	S	Corrosion-resistant and high-temperature (firewall) applications
Nickel aluminum bronze	B	Exposed marine environments

TABLE-IV FINISH CODES			
Finish Description	Color	Finish Code	Typical Applications
Cadmium per QQ-P-416, Type II, Class 3 over electroless nickel (500 hour salt-spray-resistant finish)	Olive Drab	B	Corrosion resistance for exposed environments
Electroless nickel, per AMS-C-26074 Class 4, Grade B	Bright	C	High conductivity for optimum screening performance
Anodized, hard, per MIL-A-8625 Type III, Class 2	Black	G	Nonconductive finish for aluminum adapters
Passivated, per QQ-P-35 or MIL-S 5002	-	J	Surface treatment for aluminum adapters
Unplated, shotblast	-	W	Nonreflective finish for nickel aluminum bronze adapters
Zinc Nickel	Black	Z	Cadmium free plating

TABLE-V MANUFACTURER	
MANUFACTURER CODE	CONNECTOR MANUFACTURER
A	AMPHENOL-Class A
B	BENDIX-Class A/E/R
C	CANNON-Class A/E/R
D	UNKOWN-Class A/E/R
R	AMPHENOL-Class R
-	Manufacturer code not required

ATX21 – TINEL-LOCK SHIELDED BACKSHELL

CONNECTOR INTERFACE:

- ❖ MIL-DTL-26482 SERIES I

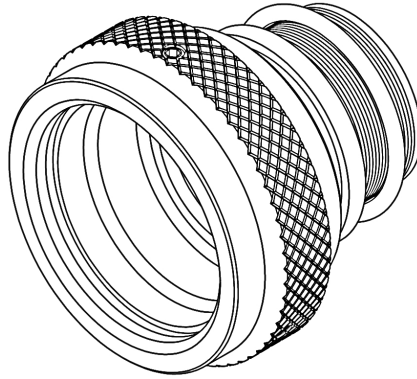

ATX	21	A	B	00	-	16	08	AI
-----	----	---	---	----	---	----	----	----

SERIES _____
 ATX- RING INCLUDED (SEE RINGS OPTION)
 AT- RING NOT INCLUDED

CONNECTOR INTERFACE _____

MATERIAL (TABLE III) _____

FINISH (TABLE IV) _____

ANGLE _____

ORDER NUMBER (TABLE I) _____

ENTRY SIZE (TABLE II) _____

RING OPTION (SEE PAGE 15-16) _____

- AI - TO SUIT SINGLE BRAID
- BI - TO SUIT DOUBLE BRAID



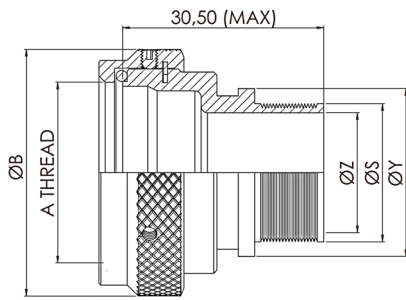

STRAIGHT BACKSHELL

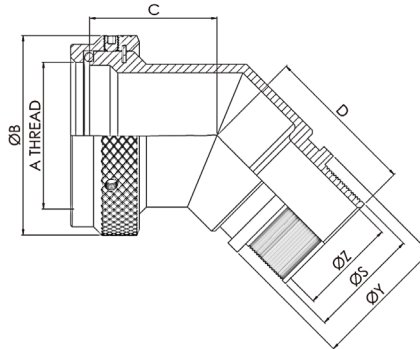

45° BACKSHELL

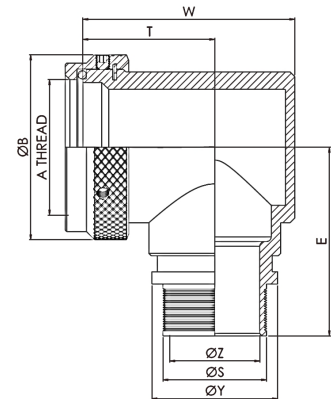

90° BACKSHELL

TABLE-I

ORDER NO.	SHELL SIZE	A THREAD	ØB MAX	MAX ENTRY	C ±0,5	D ±0,5	W ±0,5	T ±0,5	E ±0,5	THESE DIMENSIONS APPLY IF BACKSHELL IS STAINLESS STEEL OR NICKEL ALUMINIUM BRONZE		
										W ±0,5	T ±0,5	E ±0,5
08	08	7/16-28UNEF	19,0	04	13,9	26,8	25,0	17,5	26,20	22,5	17,5	26,4
10	10	9/16-24UNEF	21,5	06	14,7	27,5	28,0	18,6	27,95	25,8	18,6	28,2
12	12	11/16-24UNEF	25,0	08	15,1	28,0	31,5	20,5	29,45	29,5	20,5	29,7
14	14	13/16-20UNEF	28,0	10	16,0	29,0	35,0	22,5	31,00	32,7	22,5	31,2
16	16	15/16-20UNEF	31,0	12	16,3	29,7	38,0	24,0	32,70	35,5	24,0	32,9
18	18	11/16-18UNEF	35,0	12	17,3	30,5	41,5	26,0	34,25	39,3	26,0	34,5
20	20	13/16-18UNEF	37,5	14	18,1	30,9	45,0	28,0	35,80	42,7	28,0	36,1
22	22	15/16-18UNEF	40,5	16	18,5	31,1	48,0	29,5	37,40	45,7	29,5	37,6
24	24	17/16-18UNEF	44,0	18	19,3	32,1	51,0	31,0	38,90	48,4	31,0	39,1

All dimensions are in millimeters (mm). Specifications and dimensions subject to change.

TABLE-II

ENTRY SIZE	ØZ MIN	ØS	ØY ±0,3
04	6,35	9,49 ± 0,04	14,0
05	7,92	11,06 ± 0,04	15,5
06	9,53	12,66 ± 0,04	17,1
07	11,10	14,21 ± 0,07	18,7
08	12,70	15,81 ± 0,07	20,3
10	15,88	18,96 ± 0,08	23,5
12	19,05	22,14 ± 0,08	26,7
14	22,23	25,30 ± 0,08	29,8
16	25,40	28,48 ± 0,08	33,0
18	28,58	31,65 ± 0,08	36,2
20	31,75	34,83 ± 0,08	39,4
22	34,93	37,98 ± 0,08	42,5
24	38,10	41,15 ± 0,08	45,7

TABLE-III MATERIAL CODES

Material	Material Code	Typical Applications
Aluminum alloy	A	Standard material for normal applications
Stainless steel	S	Corrosion-resistant and high-temperature (firewall) applications
Nickel aluminum bronze	B	Exposed marine environments

TABLE-IV FINISH CODES

Finish Description	Color	Finish Code	Typical Applications
Cadmium per QQ-P-416, Type II, Class 3 over electroless nickel (500 hour salt-spray-resistant finish)	Olive Drab	B	Corrosion resistance for exposed environments
Electroless nickel, per AMS-C-26074 Class 4, Grade B	Bright	C	High conductivity for optimum screening performance
Anodized, hard, per MIL-A-8625 Type III, Class 2	Black	G	Nonconductive finish for aluminum adapters
Passivated, per QQ-P-35 or MIL-S 5002	-	J	Surface treatment for aluminum adapters
Unplated, shotblast	-	W	Nonreflective finish for nickel aluminum bronze adapters
Zinc Nickel	Black	Z	Cadmium free plating



ATX40 – TINEL-LOCK SHIELDED BACKSHELL

CONNECTOR INTERFACE:

- ❖ MIL-DTL-38999 SERIES III & IV
- ❖ EN3645

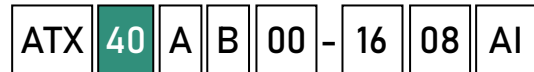
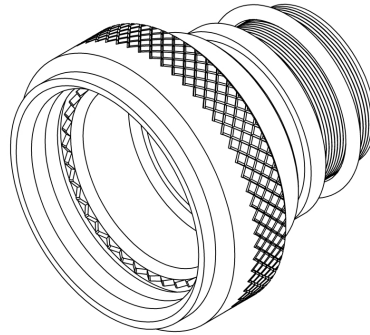

SERIES _____
 ATX- RING INCLUDED (SEE RINGS OPTION)
 AT- RING NOT INCLUDED

CONNECTOR INTERFACE _____

MATERIAL (TABLE III) _____

FINISH (TABLE IV) _____

ANGLE _____

ORDER NUMBER (TABLE I) _____

ENTRY SIZE (TABLE II) _____

RING OPTION (SEE PAGE 15-16) _____

- AI – TO SUIT SINGLE BRAID
- BI – TO SUIT DOUBLE BRAID



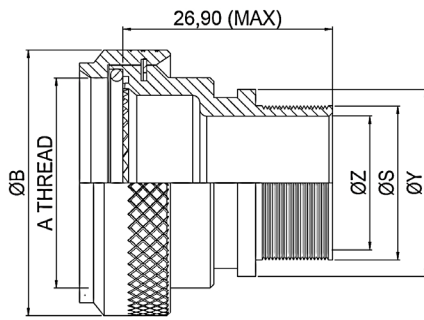

STRAIGHT BACKSHELL

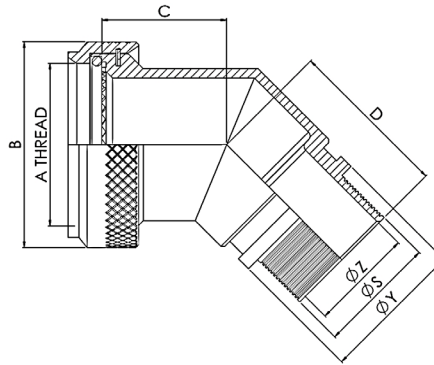

45° BACKSHELL

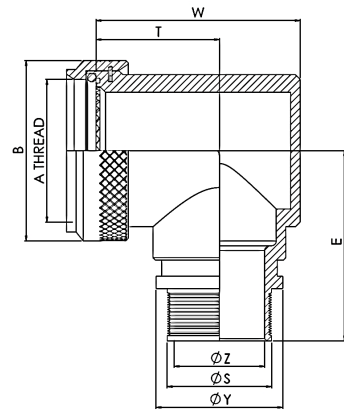

90° BACKSHELL

TABLE-I

ORDER NO.	SHELL SIZE COM'L / MIL	A THREAD	ØB MAX	MAX ENTRY	C ±0,5	D ±0,5	W ±0,5	T ±0,5	E ±0,5	THESE DIMENSIONS APPLY IF BACKSHELL IS STAINLESS STEEL OR NICKEL ALUMINIUM BRONZE		
										W ±0,5	T ±0,5	E ±0,5
08	09 / A	M12 x 1,0	18,30	04	12,0	26,8	21,0	14,0	26,20	21,2	16,3	26,4
10	11 / B	M15 x 1,0	22,00	07	12,5	27,5	24,0	15,5	27,95	24,3	17,2	28,2
12	13 / C	M18 x 1,0	24,70	08	13,1	28,0	27,0	17,0	29,45	28,3	19,4	29,7
14	15 / D	M22 x 1,0	29,25	10	13,5	29,0	31,0	19,5	31,00	31,1	21,0	31,2
16	17 / E	M25 x 1,0	33,50	12	14,5	29,7	34,0	21,0	32,70	34,2	22,8	32,9
18	19 / F	M28 x 1,0	35,75	14	15,5	30,5	35,0	20,0	34,25	38,5	25,3	34,5
20	21 / G	M31 x 1,0	38,25	16	16,1	30,9	38,0	21,5	35,80	40,7	26,1	36,1
22	23 / H	M34 x 1,0	40,70	18	16,5	31,1	42,0	24,0	37,40	43,7	27,6	37,6
24	25 / J	M37 x 1,0	43,50	20	17,0	32,1	45,0	25,5	38,90	46,4	29,1	39,1

All dimensions are in millimeters (mm). Specifications and dimensions subject to change.

TABLE-II

ENTRY SIZE	ØZ MIN	ØS	ØY ±0,3
04	6,35	9,49 ± 0,04	14,0
05	7,90	11,06 ± 0,04	15,5
06	9,50	12,66 ± 0,04	17,1
07	11,10	14,21 ± 0,07	18,7
08	12,70	15,81 ± 0,07	20,3
10	15,90	18,96 ± 0,08	23,5
12	19,05	22,14 ± 0,08	26,7
14	22,20	25,30 ± 0,08	29,8
16	25,40	28,48 ± 0,08	33,0
18	28,60	31,65 ± 0,08	36,2
20	31,75	34,83 ± 0,08	39,4
22	34,90	37,98 ± 0,08	42,5
24	38,10	41,15 ± 0,08	45,7

TABLE-III MATERIAL CODES

Material	Material Code	Typical Applications
Aluminum alloy	A	Standard material for normal applications
Stainless steel	S	Corrosion-resistant and high-temperature (firewall) applications
Nickel aluminum bronze	B	Exposed marine environments

TABLE-IV FINISH CODES

Finish Description	Color	Finish Code	Typical Applications
Cadmium per QQ-P-416, Type II, Class 3 over electroless nickel (500 hour salt-spray-resistant finish)	Olive Drab	B	Corrosion resistance for exposed environments
Electroless nickel, per AMS-C-26074 Class 4, Grade B	Bright	C	High conductivity for optimum screening performance
Anodized, hard, per MIL-A-8625 Type III, Class 2	Black	G	Nonconductive finish for aluminum adapters
Passivated, per QQ-P-35 or MIL-S 5002	-	J	Surface treatment for aluminum adapters
Unplated, shotblast	-	W	Nonreflective finish for nickel aluminum bronze adapters
Zinc Nickel	Black	Z	Cadmium free plating

ATX41 – TINEL-LOCK BACKSHELL

CONNECTOR INTERFACE:

- ❖ MIL-DTL-38999 SERIES I & II
- ❖ MIL-DTL-27599

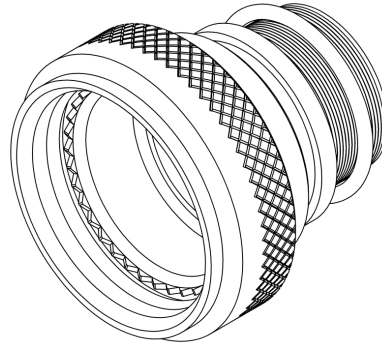

ATX	41	A	B	00	-	16	08	AI
-----	----	---	---	----	---	----	----	----

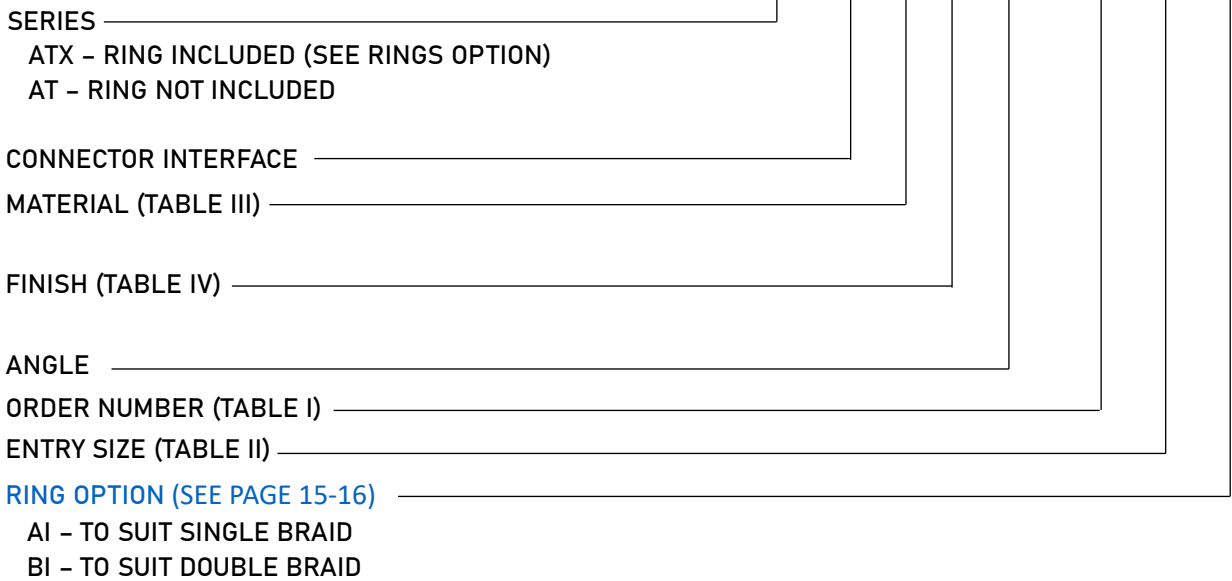

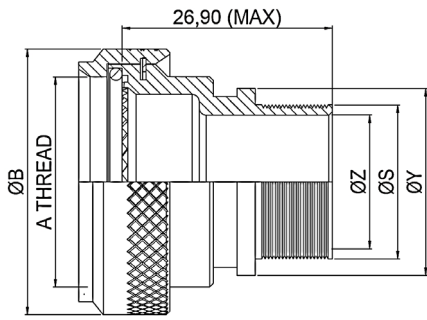

STRAIGHT BACKSHELL

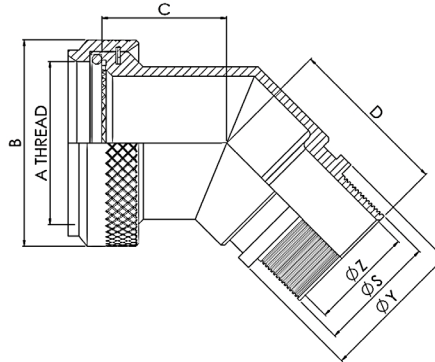

45° BACKSHELL

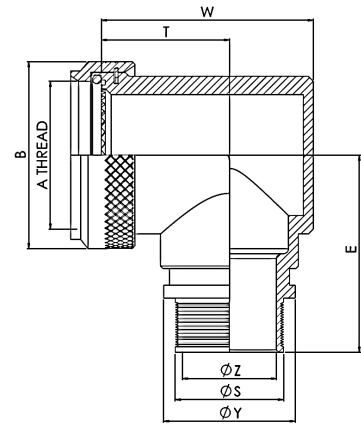

90° BACKSHELL

TABLE-I

ORDER NO.	SHELL SIZE		A THREAD	ØB MAX	MAX ENTRY	C ±0,5	D ±0,5	W ±0,5	T ±0,5	E ±0,5	THESE DIMENSIONS APPLY IF BACKSHELL IS STAINLESS STEEL OR NICKEL ALUMINIUM BRONZE		
	Series II	Series I									W ±0,5	T ±0,5	E ±0,5
	08	09									7/16-28UNEF	18,30	04
10	11	9/16-24UNEF	22,00	07	17,2	27,5	24,0	15,5	27,95	24,4	17,3	28,2	
12	13	11/16-24UNEF	24,75	08	17,6	28,0	27,0	17,0	29,45	28,4	19,5	29,7	
14	15	13/16-20UNEF	28,30	10	18,5	29,0	31,0	19,5	31,00	31,2	21,0	31,2	
16	17	15/16-20UNEF	29,50	12	19,2	29,7	34,0	21,0	32,70	34,3	22,8	32,9	
18	19	1 1/16-18UNEF	34,50	14	19,6	30,5	35,0	20,0	34,25	38,6	25,3	34,5	
20	21	1 3/16-18UNEF	36,75	16	20,4	30,9	38,0	21,5	35,80	40,8	26,1	36,1	
22	23	1 5/16-18UNEF	41,00	18	20,8	31,1	42,0	24,0	37,40	43,8	27,6	37,6	
24	25	1 7/16-18UNEF	43,75	20	21,7	32,1	45,0	25,5	38,90	46,5	29,1	39,1	

All dimensions are in millimeters (mm). Specifications and dimensions subject to change.

TABLE-II

ENTRY SIZE	ØZ MIN	ØS	ØY ±0,3
04	6,35	9,49 ± 0,04	14,0
05	7,92	11,06 ± 0,04	15,5
06	9,53	12,66 ± 0,04	17,1
07	11,10	14,21 ± 0,07	18,7
08	12,70	15,81 ± 0,07	20,3
10	15,88	18,96 ± 0,08	23,5
12	19,05	22,14 ± 0,08	26,7
14	22,23	25,30 ± 0,08	29,8
16	25,40	28,48 ± 0,08	33,0
18	28,58	31,65 ± 0,08	36,2
20	31,75	34,83 ± 0,08	39,4
22	34,93	37,98 ± 0,08	42,5
24	38,10	41,15 ± 0,08	45,7

TABLE-III MATERIAL CODES

Material	Material Code	Typical Applications
Aluminum alloy	A	Standard material for normal applications
Stainless steel	S	Corrosion-resistant and high-temperature (firewall) applications
Nickel aluminum bronze	B	Exposed marine environments

TABLE-IV FINISH CODES

Finish Description	Color	Finish Code	Typical Applications
Cadmium per QQ-P-416, Type II, Class 3 over electroless nickel (500 hour salt-spray-resistant finish)	Olive Drab	B	Corrosion resistance for exposed environments
Electroless nickel, per AMS-C-26074 Class 4, Grade B	Bright	C	High conductivity for optimum screening performance
Anodized, hard, per MIL-A-8625 Type III, Class 2	Black	G	Nonconductive finish for aluminum adapters
Passivated, per QQ-P-35 or MIL-S 5002	-	J	Surface treatment for aluminum adapters
Unplated, shotblast	-	W	Nonreflective finish for nickel aluminum bronze adapters
Zinc Nickel	Black	Z	Cadmium free plating



ATX47 - TINEL-LOCK BACKSHELL

CONNECTOR INTERFACE:

❖ VG96912 SERIES I

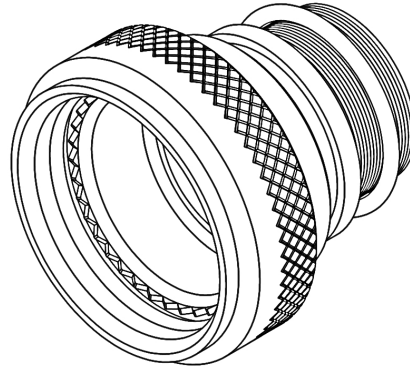

ATX	47	A	B	00	-	16	08	AI
-----	----	---	---	----	---	----	----	----

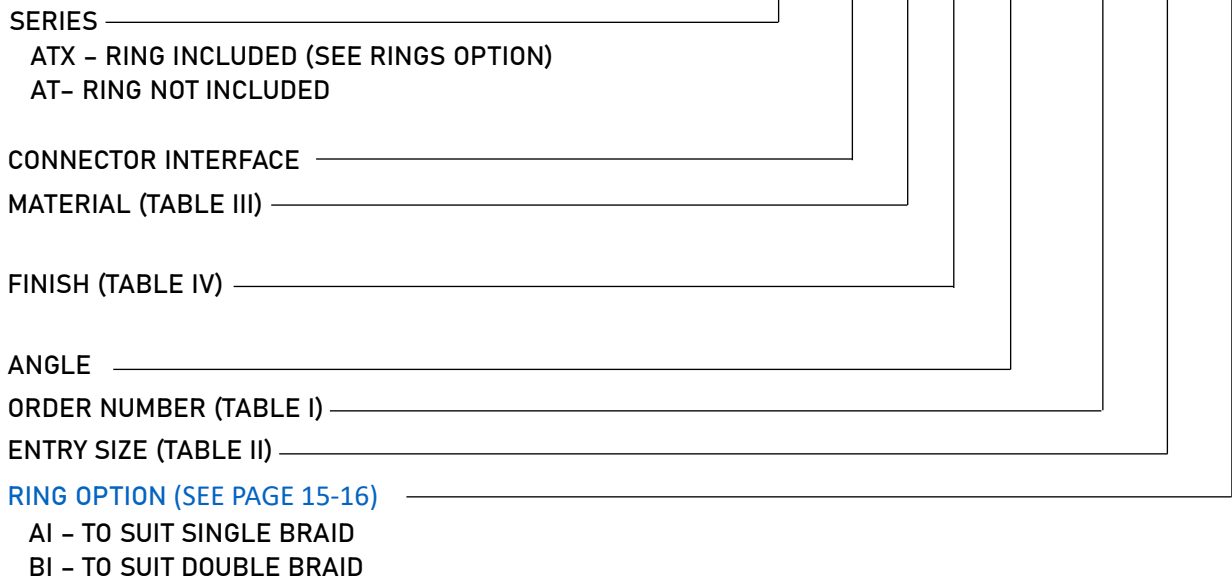

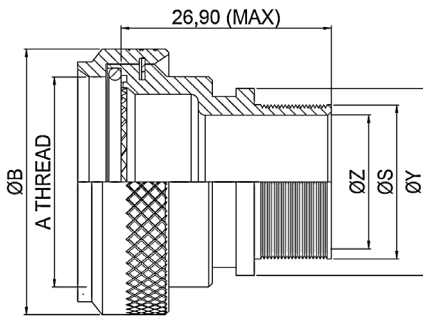

STRAIGHT BACKSHELL

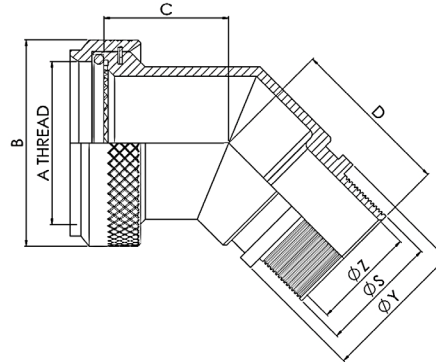

45° BACKSHELL

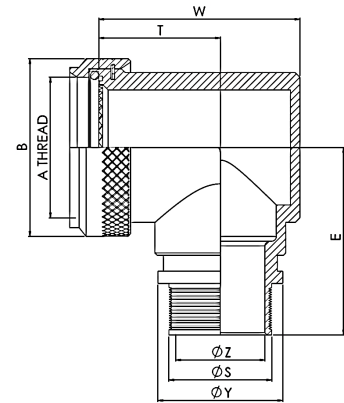

90° BACKSHELL

TABLE-I															
ORDER NO.	SHELL SIZE				A THREAD	ØB MAX	MAX ENTRY	C ±0,5	D ±0,5	W ±0,5	T ±0,5	E ±0,5	THESE DIMENSIONS APPLY IF BACKSHELL IS STAINLESS STEEL OR NICKEL ALUMINIUM BRONZE		
	SJT 00	VG96912	SJT 07	VG96912									W ±0,5	T ±0,5	E ±0,5
	SJT 06	Style A, E, D													
08	08				7/16-28UNEF	18,30	04	16,4	26,8	21,0	14,0	26,2	21,3	16,4	26,4
10	10				9/16-24UNEF	22,00	07	17,2	27,5	24,0	15,5	28,0	24,4	17,3	28,2
12	12				11/16-24UNEF	25,00	08	17,6	28,0	27,0	17,0	29,5	28,4	19,5	29,7
14	14				13/16-20UNEF	28,30	10	18,5	29,0	31,0	19,5	31,0	31,2	21,0	31,2
16	16				15/16-20UNEF	31,00	12	19,2	29,7	34,0	21,0	32,7	34,3	22,8	32,9
18	18				1 1/16-18UNEF	34,50	14	19,6	30,5	35,0	20,0	34,3	38,6	25,3	34,5
20	20				1 3/16-18UNEF	36,80	16	20,4	30,9	38,0	21,5	35,8	40,8	26,1	36,1
22	22				1 5/16-18UNEF	41,00	18	20,8	31,1	42,0	24,0	37,4	43,8	27,6	37,6
24	24				1 7/16-18UNEF	43,75	20	21,7	32,1	45,0	25,5	38,9	46,5	29,1	39,1

All dimensions are in millimeters (mm). Specifications and dimensions subject to change.

TABLE-II			
ENTRY SIZE	ØZ MIN	ØS	ØY ±0,3
04	6,35	9,49 ± 0,04	14,0
05	7,90	11,06 ± 0,04	15,5
06	9,50	12,66 ± 0,04	17,1
07	11,10	14,21 ± 0,07	18,7
08	12,70	15,81 ± 0,07	20,3
10	15,90	18,96 ± 0,08	23,5
12	19,05	22,14 ± 0,08	26,7
14	22,20	25,30 ± 0,08	29,8
16	25,40	28,48 ± 0,08	33,0
18	28,60	31,65 ± 0,08	36,2
20	31,75	34,83 ± 0,08	39,4
22	34,90	37,98 ± 0,08	42,5
24	38,10	41,15 ± 0,08	45,7

TABLE-III MATERIAL CODES		
Material	Material Code	Typical Applications
Aluminum alloy	A	Standard material for normal applications
Stainless steel	S	Corrosion-resistant and high-temperature (firewall) applications
Nickel aluminum bronze	B	Exposed marine environments

TABLE-IV FINISH CODES			
Finish Description	Color	Finish Code	Typical Applications
Cadmium per QQ-P-416, Type II, Class 3 over electroless nickel (500 hour salt-spray-resistant finish)	Olive Drab	B	Corrosion resistance for exposed environments
Electroless nickel, per AMS-C-26074 Class 4, Grade B	Bright	C	High conductivity for optimum screening performance
Anodized, hard, per MIL-A-8625 Type III, Class 2	Black	G	Nonconductive finish for aluminum adapters
Passivated, per QQ-P-35 or MIL-S 5002	-	J	Surface treatment for aluminum adapters
Unplated, shotblast	-	W	Nonreflective finish for nickel aluminum bronze adapters
Zinc Nickel	Black	Z	Cadmium free plating



ATX54 - TINEL-LOCK BACKSHELL

CONNECTOR INTERFACE:

- ❖ MIL-DTL-26482 SERIES II
- ❖ MIL-DTL-81703 SERIES I & II
- ❖ MIL-DTL-5015 CRIMP
- ❖ MIL-DTL-27599

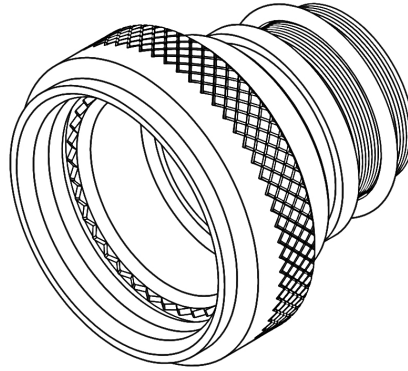

ATX	54	A	B	00	-	16	08	AI
-----	----	---	---	----	---	----	----	----

SERIES _____
 ATX - RING INCLUDED (SEE RINGS OPTION)
 AT - RING NOT INCLUDED

CONNECTOR INTERFACE _____

MATERIAL (TABLE III) _____

FINISH (TABLE IV) _____

ANGLE _____

ORDER NUMBER (TABLE I) _____

ENTRY SIZE (TABLE II) _____

RING OPTION (SEE PAGE 15-16) _____

- AI - TO SUIT SINGLE BRAID
- BI - TO SUIT DOUBLE BRAID

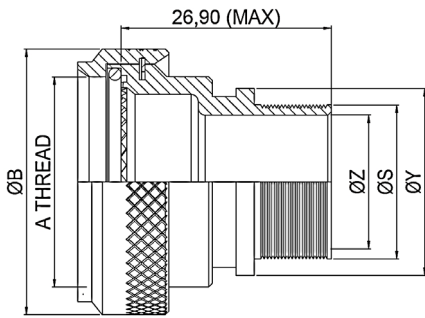

STRAIGHT BACKSHELL

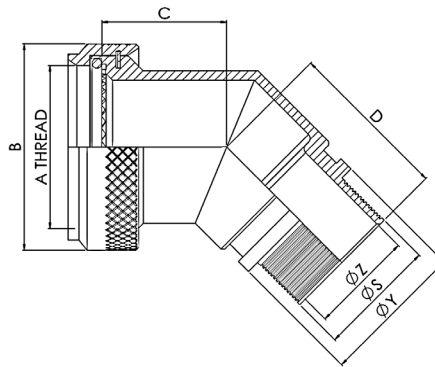

45° BACKSHELL

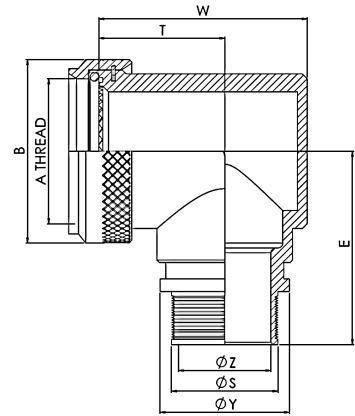

90° BACKSHELL

TABLE-I

ORDER NO.			A THREAD	ØB MAX	MAX ENTRY	C ±0,5	D ±0,5	W ±0,5	T ±0,5	E ±0,5	THESE DIMENSIONS APPLY IF BACKSHELL IS STAINLESS STEEL OR NICKEL ALUMINIUM BRONZE		
SHELL SIZE											W ±0,5	T ±0,5	E ±0,5
MIL-DTL-5015 Crimp	MIL-C-81703 Series III	MIL-DTL-26482 Series II											
-	3	-	9/16-24 UNEF	17,00	04	16,8	27,0	26,4	17,8	25,9	26,3	16,0	25,9
8 & 8S	-	8	1/2-20 UNF	18,50	04	16,6	26,8	24,5	17,5	26,2	22,4	17,5	26,2
10, 10S & 10SL	-	10	5/8-24 UNEF	22,75	06	16,8	27,5	26,5	17,8	28,0	25,0	18,8	28,0
12 & 12S	7	12	3/4-20 UNEF	26,00	08	17,3	28,0	29,0	18,7	29,5	28,3	20,4	29,5
14 & 14S	12	14	7/8-20 UNEF	30,00	08	18,1	29,0	30,5	19,0	30,3	30,4	21,5	31,0
16 & 16S	19	16	1-20 UNEF	33,25	10	19,0	29,7	34,0	21,0	32,7	33,5	23,0	32,7
18	27	18	1 1/16-18 UNEF	34,50	12	19,2	30,5	37,0	23,5	32,7	35,5	24,0	32,7
20	37	20	1 3/16-18 UNEF	37,30	14	20,1	30,9	42,0	27,0	34,3	38,8	25,7	34,3
22	-	22	1 5/16-18 UNEF	41,00	16	20,3	31,1	44,0	27,0	35,8	41,9	27,2	35,8
24	-	24	1 7/16-18 UNEF	43,50	18	21,8	32,1	45,0	27,0	37,4	44,8	28,7	37,4
28	-	-	1 3/4-18UNS	50,00	22	23,3	32,5	54,2	31,4	41,9	50,7	31,6	41,9
32	-	-	2-18 UNS	58,00	24	25,0	29,3	60,9	36,4	45,3	60,0	33,5	45,3
36	-	-	2 1/4-16 UN	64,50	28	26,2	30,7	67,2	38,0	48,4	65,5	36,0	48,4
40	-	-	2 1/2-16 UN	70,75	28	28,6	32,0	73,2	41,0	51,4	72,0	39,3	51,4
44	-	-	2 3/4-16 UN	77,00	28	30,1	33,7	79,5	44,1	54,6	75,5	40,8	54,6
48	-	-	3-16UN	83,50	28	31,3	34,9	85,8	47,2	57,7	75,5	40,8	57,7
-	61	-	1 1/2-18 UNEF	45,40	18	22,1	26,6	47,8	28,0	38,7	48,3	27,0	38,7

All dimensions are in millimeters (mm). Specifications and dimensions subject to change.

TABLE-II

ENTRY SIZE	ØZ MIN	ØS	ØY ±0,3
04	6,35	9,49 ± 0,04	14,0
05	7,92	11,06 ± 0,04	15,5
06	9,53	12,66 ± 0,04	17,1
07	11,10	14,21 ± 0,07	18,7
08	12,70	15,81 ± 0,07	20,3
10	15,88	18,96 ± 0,08	23,5
12	19,05	22,14 ± 0,08	26,7
14	22,23	25,30 ± 0,08	29,8
16	25,40	28,48 ± 0,08	33,0
18	28,58	31,65 ± 0,08	36,2
20	31,75	34,83 ± 0,08	39,4
22	34,93	37,98 ± 0,08	42,5
24	38,10	41,15 ± 0,08	45,7
28	44,45	47,50 ± 0,08	52,0

TABLE-III MATERIAL CODES

Material	Material Code	Typical Applications
Aluminum alloy	A	Standard material for normal applications
Stainless steel	S	Corrosion-resistant and high-temperature (firewall) applications
Nickel aluminum bronze	B	Exposed marine environments

TABLE-IV FINISH CODES

Finish Description	Color	Finish Code	Typical Applications
Cadmium per QQ-P-416, Type II, Class 3 over electroless nickel (500 hour salt-spray-resistant finish)	Olive Drab	B	Corrosion resistance for exposed environments
Electroless nickel, per AMS-C-26074 Class 4, Grade B	Bright	C	High conductivity for optimum screening performance
Anodized, hard, per MIL-A-8625 Type III, Class 2	Black	G	Nonconductive finish for aluminum adapters
Passivated, per QQ-P-35 or MIL-S 5002	-	J	Surface treatment for aluminum adapters
Unplated, shotblast	-	W	Nonreflective finish for nickel aluminum bronze adapters
Zinc Nickel	Black	Z	Cadmium free plating



TINEL-LOCK RING

SCOPE:

THIS SPECIFICATION PROVIDES A DESCRIPTION OF HEAT SHRINKABLE METAL RINGS FOR TERMINATING BRAIDED SHIELD ONTO ADAPTORS DESIGNED FOR THAT PURPOSE.

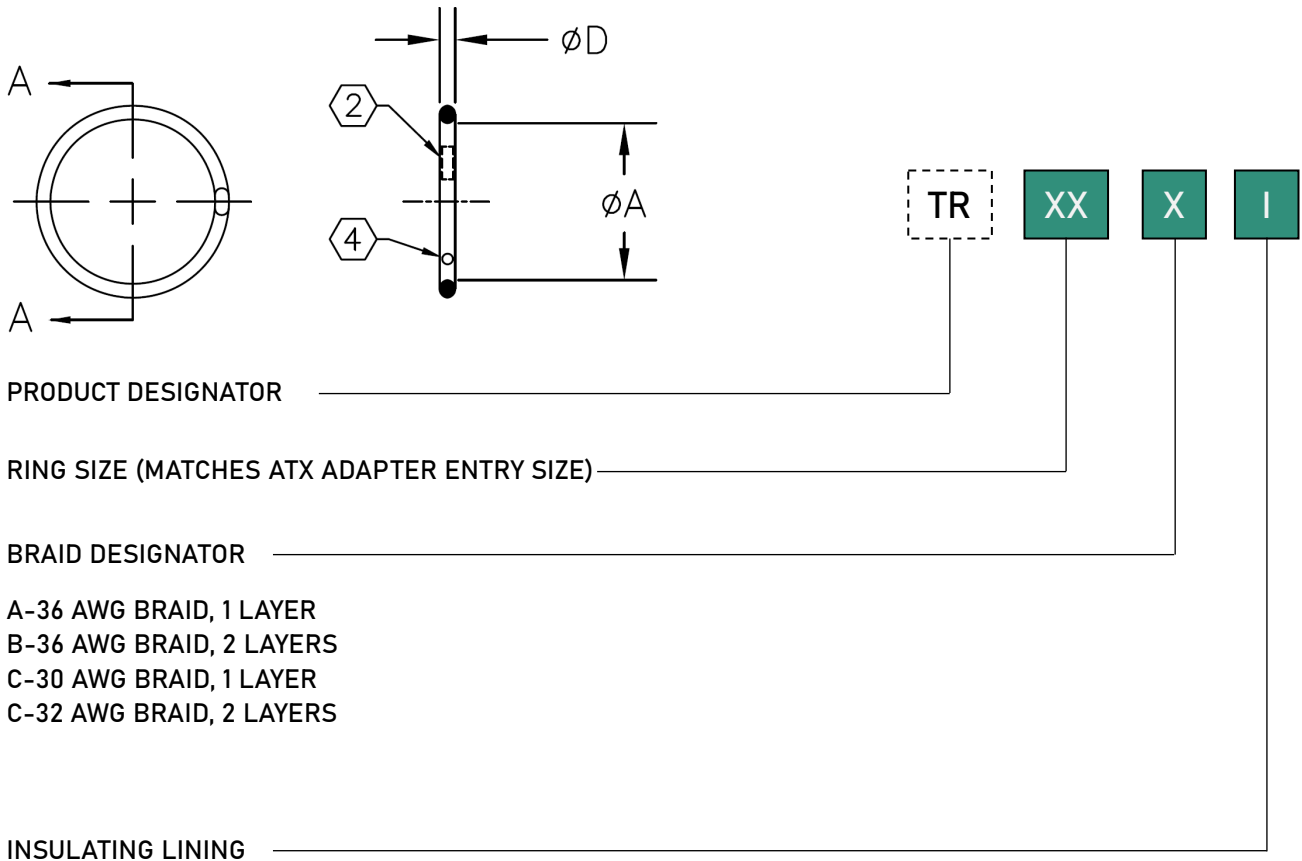

- A-36 AWG BRAID, 1 LAYER
- B-36 AWG BRAID, 2 LAYERS
- C-30 AWG BRAID, 1 LAYER
- C-32 AWG BRAID, 2 LAYERS

NOTES:

1. MATERIAL: TINEL ALLOY X.
2. THE OUTSIDE SURFACE OF THE RING IS MARKED WITH TWO STRIPES OF THERMOCHROMIC PAINT WHICH CHANGE COLOR WHEN THE APPROPRIATE INSTALLATION TEMPERATURE IS REACHED.
3. "AI" RINGS ARE IDENTIFIED BY THE ABSENCE OF A RED OR BLUE DOT. REFER TO NOTE 4.
4. "BI" RINGS ARE MARKED WITH A RED DOT.
"CI" RINGS ARE MARKED WITH A BLUE DOT.

PART DESCRIPTION	ØA		ØD	
	MIN AS SUPPLIED	MAX FREE RECOVERED		
TR04AI	.397 [10,08]	.379 [9,63]	.073 ± .005	[1,85 ± 0,13]
TR04BI	.416 [10,57]	.398 [10,11]	.073 ± .005	[1,85 ± 0,13]
TR05AI	.460 [11,68]	.440 [11,18]	.073 ± .005	[1,85 ± 0,13]
TR05BI	.479 [12,17]	.458 [11,63]	.073 ± .005	[1,85 ± 0,13]
TR06AI	.523 [13,28]	.499 [12,68]	.073 ± .005	[1,85 ± 0,13]
TR06BI	.548 [13,92]	.523 [13,28]	.073 ± .005	[1,85 ± 0,13]
TR07AI	.586 [14,88]	.559 [14,20]	.073 ± .005	[1,85 ± 0,13]
TR07BI	.606 [15,39]	.578 [14,68]	.073 ± .005	[1,85 ± 0,13]
TR08AI	.650 [16,51]	.620 [15,75]	.073 ± .005	[1,85 ± 0,13]
TR08BI	.670 [17,02]	.639 [16,23]	.073 ± .005	[1,85 ± 0,13]
TR10AI	.782 [19,86]	.744 [18,90]	.073 ± .005	[1,85 ± 0,13]
TR10BI	.802 [20,37]	.763 [19,38]	.073 ± .005	[1,85 ± 0,13]
TR10CI	.830 [21,08]	.791 [20,09]	.073 ± .005	[1,85 ± 0,13]
TR12AI	.912 [23,17]	.867 [22,02]	.073 ± .005	[1,85 ± 0,13]
TR12BI	.931 [23,65]	.886 [22,50]	.073 ± .005	[1,85 ± 0,13]
TR12CI	.960 [24,38]	.912 [23,17]	.073 ± .005	[1,85 ± 0,13]
TR14AI	1.040 [26,42]	.988 [25,10]	.073 ± .005	[1,85 ± 0,13]
TR14BI	1.060 [26,92]	1.007 [25,58]	.073 ± .005	[1,85 ± 0,13]
TR14CI	1.089 [27,66]	1.033 [26,24]	.073 ± .005	[1,85 ± 0,13]
TR16AI	1.171 [29,74]	1.111 [28,22]	.073 ± .005	[1,85 ± 0,13]
TR16BI	1.191 [30,25]	1.129 [28,68]	.073 ± .005	[1,85 ± 0,13]
TR16CI	1.216 [30,89]	1.154 [29,31]	.073 ± .005	[1,85 ± 0,13]
TR18AI	1.301 [33,05]	1.234 [31,34]	.073 ± .005	[1,85 ± 0,13]
TR18BI	1.320 [33,53]	1.252 [31,80]	.073 ± .005	[1,85 ± 0,13]
TR20AI	1.430 [36,32]	1.357 [34,47]	.073 ± .005	[1,85 ± 0,13]
TR20BI	1.450 [36,83]	1.376 [34,95]	.073 ± .005	[1,85 ± 0,13]
TR22AI	1.543 [39,19]	1.463 [37,16]	.088 ± .007	[2,24 ± 0,18]
TR22BI	1.561 [39,65]	1.481 [37,62]	.088 ± .007	[2,24 ± 0,18]
TR24AI	1.673 [42,49]	1.587 [40,31]	.088 ± .007	[2,24 ± 0,18]
TR24BI	1.691 [42,95]	1.605 [40,77]	.088 ± .007	[2,24 ± 0,18]
TR28AI	1.932 [49,07]	1.838 [46,68]	.088 ± .007	[2,24 ± 0,18]
TR28BI	1.950 [49,53]	1.858 [47,19]	.088 ± .007	[2,24 ± 0,18]

Dimensions in brackets [] are in millimeters.





ATP DEFENSE

© 2026

BACKSHELLS

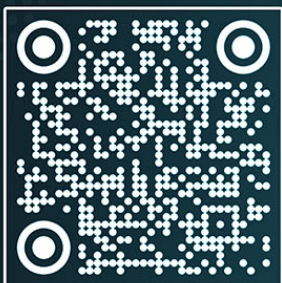

NCAGE: TD589

www.atpsavunma.com